

YOUR STORY MADE UNFORGETTABLE



TABLE OF CONTENTS

ABOUT EXHIBIT CONCEPTS	3-4
Our History	3
Experiential Learning Related Products.....	4
Services & Capabilities.....	5
Experiential Education	6
PERMANENT CLASSROOMS VS. CONVERTIBLE CLASSROOMS	7-9
Permanent Classrooms	7
Convertible Classrooms	9
EXPERIENTIAL EDUCATION SAMPLES.....	10-22
DISCOVERY & DESIGN	23-26
Schematic Design	24
Conceptual Design	25
Final Design	26
ACTIVITY & CLASSROOM RESOURCES	27-30
PRODUCTION & FABRICATION.....	31-36
Space Prep Drawings	32
Shop Drawings	33
Fabrication.....	34
Installation.....	35
Maintenance & Support	36
OUR COMPREHENSIVE SERVICES	37-41
RESULTS	42

OUR HISTORY

Established 1978 - Second Generation Owned
Certified Womens Business Enterprise
 Corporate Headquarters in Dayton, Ohio | Chicago
 200K+ Square Feet of Production & Warehousing
 Over 1,895 Projects Annually
 Over 100 Employees



DR. SARAH JANDRUCKO ACADEMY FOR EARLY LEARNERS

Since its establishment in 1978, Exhibit Concepts has been committed to the full realization of any institution's master plan and exhibit designs.

Our approach is to create a team of professionals, consisting of our in-house staff as well as outside specialists, whose talents match the requirements of the project.

Our team is dedicated to producing exhibitry of the highest quality. We take great care to thoroughly understand your ideas and translate them into an interactive classroom that accomplishes your desired objectives.

Our in-house staff of professional designers, curriculum specialist, model makers, graphic production technicians and structural fabricators have over five centuries of cumulative experience.



Exhibit Concepts is a Woman Owned Business and is certified through the Women's Business Enterprise National Council (Certification #2005117249).



EXPERIENTIAL LEARNING RELATED PROJECTS

Dr. Sarah Jandrucko Academy, Mansfield, TX

Region 7- ECOLAND, Kilgore, TX

Region 2- Early Scholars Academy, Corpus Christi, TX

Region 19- IntelliZeum, El Paso, TX & NatureZeum, Fabens, TX

CDC Head Start- RISE Academy, Columbus, OH

Aullwood Audubon Center and Farm, Dayton, OH

Avilla Elementary School, Avilla, IN

Martinez Early Learning Center, Alief ISD, Houston, TX

Jefferson Early Learning Center, Alief ISD, Houston, TX

Sheila C. Liles Early Learning Academy, Goose Creek CISD, Baytown, TX

Jessie Lee Pumphrey Elementary, Goose Creek CISD, Baytown, TX

“The objective of education is to prepare the young to educate themselves throughout their lives.”

– Robert Maynard Hutchins

SERVICES & CAPABILITIES



DR. SARAH JANDRUCKO ACADEMY FOR EARLY LEARNERS

Our company is full of creative and passionate people dedicated to providing unique solutions and excellent customer experiences for:

- experiential education (19 Years of Experience)
- museums (34 Years of Experience)
- trade show exhibits (44 Years of Experience)
- corporate events (26 Years of Experience)
- interior environments (27 Years of Experience)
- mobile vehicle tours (22 Years of Experience)
- experiences and engagements (44 Years of Experience)
- virtual solutions (5 Years of Experience)

EXPERIENTIAL EDUCATION

Exhibit Concepts is the leading provider of turnkey solutions for interactive, fully immersive education. Since 2003, we have transformed traditional educational institutions, for early learners and beyond, into museum-quality, interactive learning experiences.

We are the only design build firm to offer curriculum support, activities, and resources that are unique to each themed learning environment. These teaching tools are developed in collaboration with professional educators and are designed to meet educational standards as well as encourage multi-sensory instruction within each creatively designed space.

The Exhibit Concepts team addresses every detail from initial brainstorming to a completely designed and fabricated space, including curricular plans and activities. These immersive learning experiences inspire educators to encourage a love of learning in children that will last a lifetime.



PERMANENT CLASSROOMS



CONVERTIBLE CLASSROOMS



PERMANENT CLASSROOMS



Permanent experiential classrooms can be designed within a new building or existing space. These permanent spaces are meant to remain one theme that requires minimal management from staff.

These spaces are built with the quality to stand the test of time and tiny hands. Each immersive space utilizes our custom-themed classroom activity kits and accompanied training, which gives education continuing education units.

Permanent classrooms are ideal for districts with new construction on the horizon, existing spaces that need an update, or if your community is looking for a competitive edge.

CONVERTIBLE CLASSROOMS

Convertible classrooms create environments that mimic permanent experiential classrooms' visual style and design. One key factor separating convertible classrooms from permanent is that these rooms are for temporary use, and display elements must be easily managed by school staff.

The budget-friendly, convertible classrooms still utilize our custom-themed classroom activity kits and accompany training, which gives educators continuing education units.

Convertible classrooms are ideal for districts facing budget constraints, dealing with limited space and resources, would prefer an expedited roll-out instead of new construction, or if you're looking to transform existing classrooms.



EXPERIENTIAL EDUCATION SAMPLES

Space | Discovery | Community | Our World
Agriculture | Plants | Animals



SPACE



Academy for Early Learners
Mansfield ISD



SPACE



Micronauts Space Station
Rendering



IntelliZeum
Region 19 Education Service Center

DISCOVERY



Ecoland
Region 7 Education Service Center



Jessie Lee Pumphrey Elementary
Goose Creek CISD

COMMUNITY



Academy for Early Learners
Mansfield ISD



Academy for Early Learners
Mansfield ISD

COMMUNITY



Alief Independent School District (Convertible)
Houston, Texas



Academy for Early Learners (Permanent)
Mansfield ISD

COMMUNITY



RISE Academy – Rendering
Child Development
Council of Franklin County



Academy for Early Learners
Mansfield ISD

OUR WORLD



RISE Academy – Rendering
Child Development
Council of Franklin County



Jessie Lee Pumphrey Elementary
Goose Creek CISD

OUR WORLD



Alief Independent School District (Convertible)
Houston, Texas



Academy for Early Learners (Permanent)
Mansfield ISD

PLANTS



Academy for Early Learners
Mansfield ISD



Ecoland –Rendering
Region 7 Education Service Center

ANIMALS



Academy for Early Learners
Mansfield ISD



Academy for Early Learners
Mansfield ISD

ANIMALS



Alief Independent School District (Convertible)
Houston, Texas



Academy for Early Learners (Permanent)
Mansfield ISD

ANIMALS



Avilla Elementary School
East Noble School Corporation



Aullwood Audubon Center and Farm
Farm Exhibits

DISCOVERY

Schematic Design | Conceptual Design | Final Design

& DESIGN



SCHEMATIC DESIGN

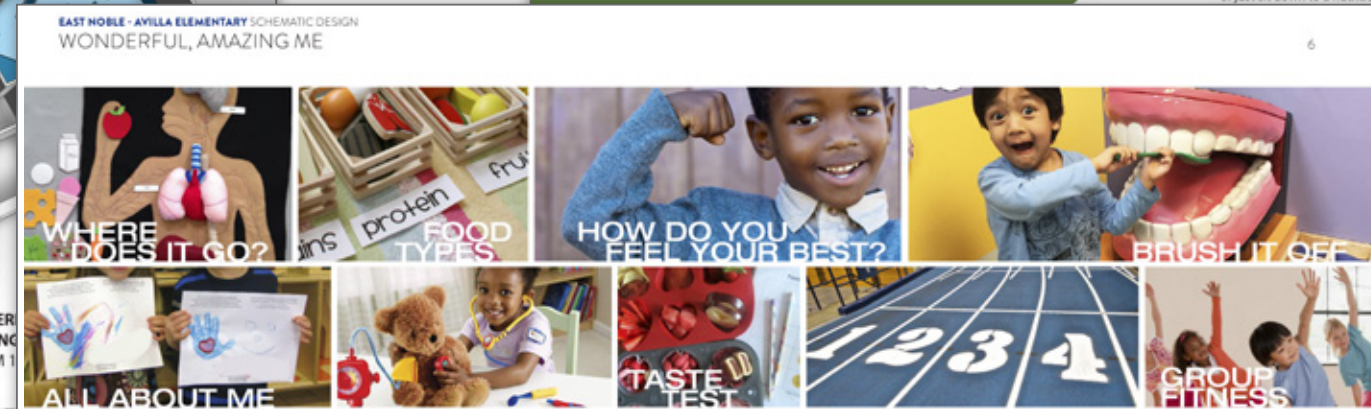
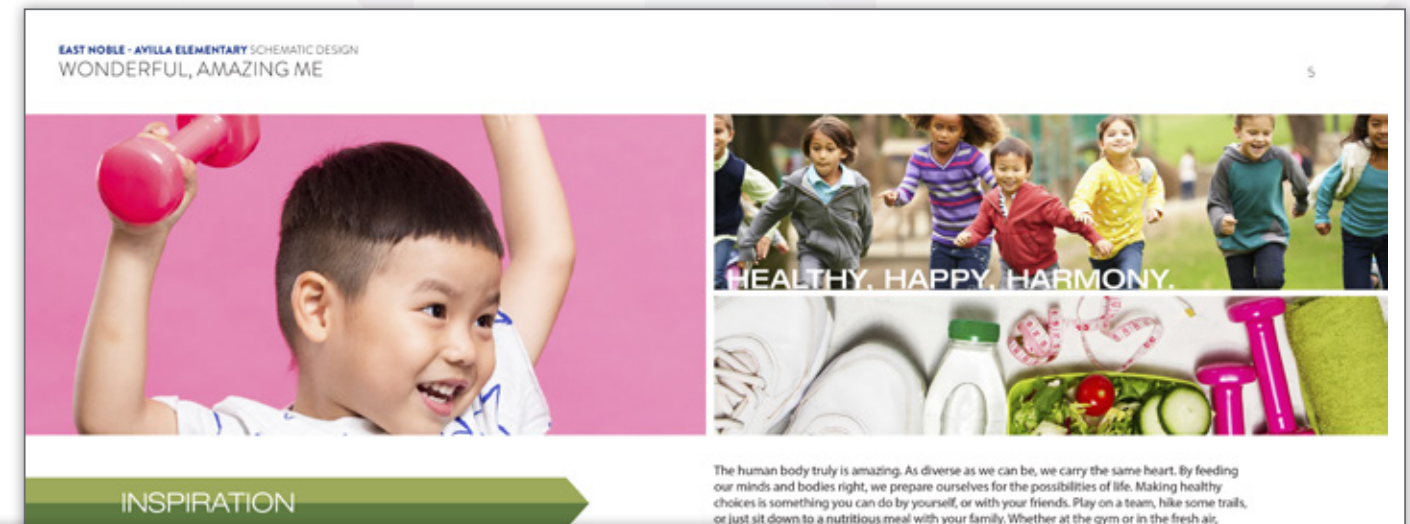
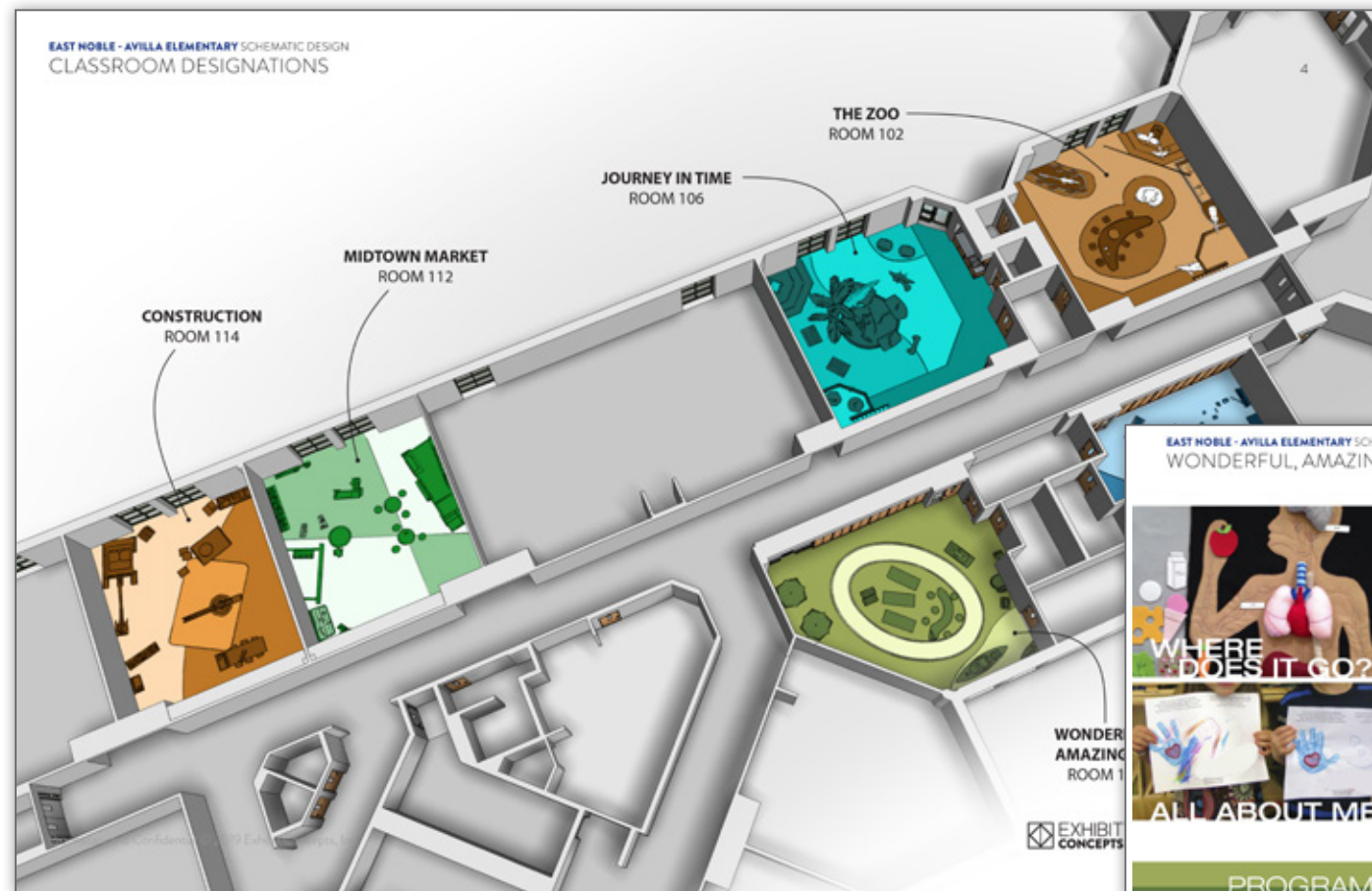

- Conceptual Flow-Plans
- Design Inspiration
- Programming Possibilities

CONCEPTUAL DESIGN

1

SPACE THE DESIGN INTENT

The universe is vast and most certainly awe-inspiring. While the story told inside the **Space** room ends at the edges of our solar system, it still offers an amazing view of the stars. Beautiful images from the Hubble Telescope encompass the walls surrounding a rocket ship that awaits in the center of the room. The textures of each planet dot the colorful palette of the cosmos, begging the children to explore the possibilities of this new found frontier, turning their eyes to the heavens and letting imaginations take flight.



- Design Intent
- Realistic Renderings
- Detailed Floor-Plans

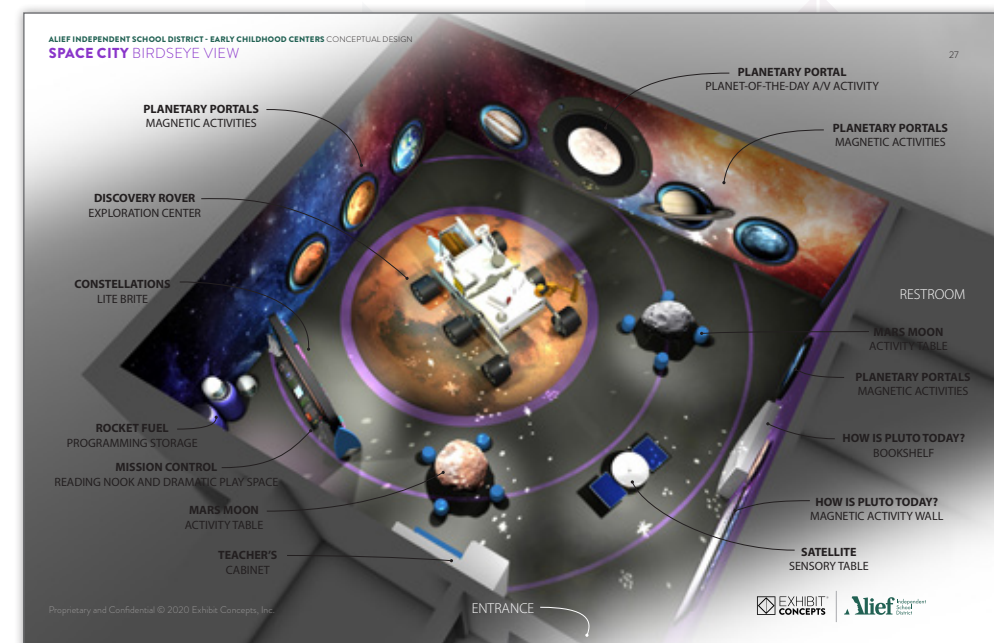
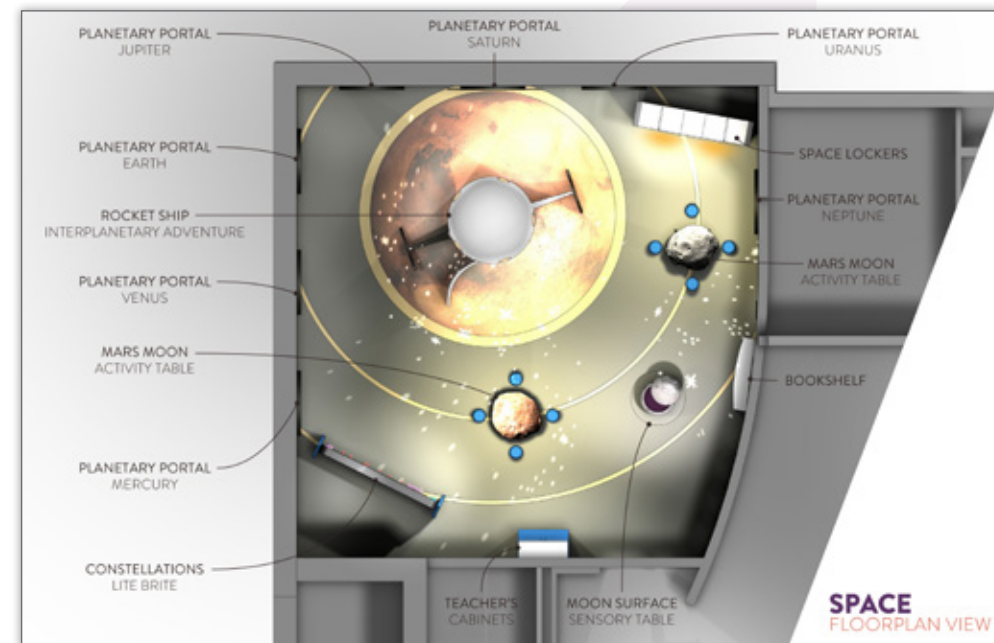

FINAL DESIGN

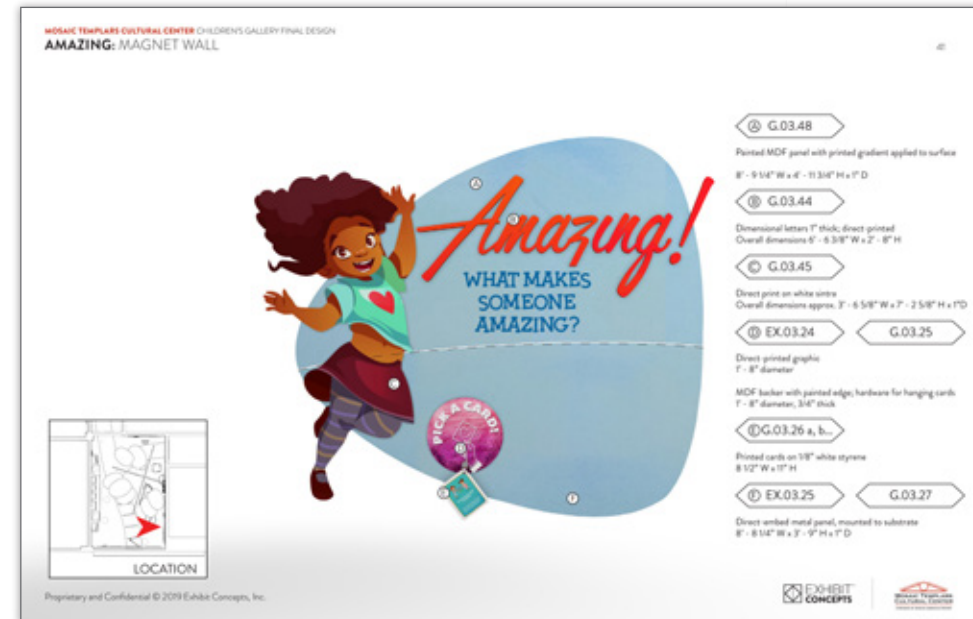

- Final Renderings
- Graphics and Scenic Call-Outs
- Final Finishes
- Space Prep Drawings

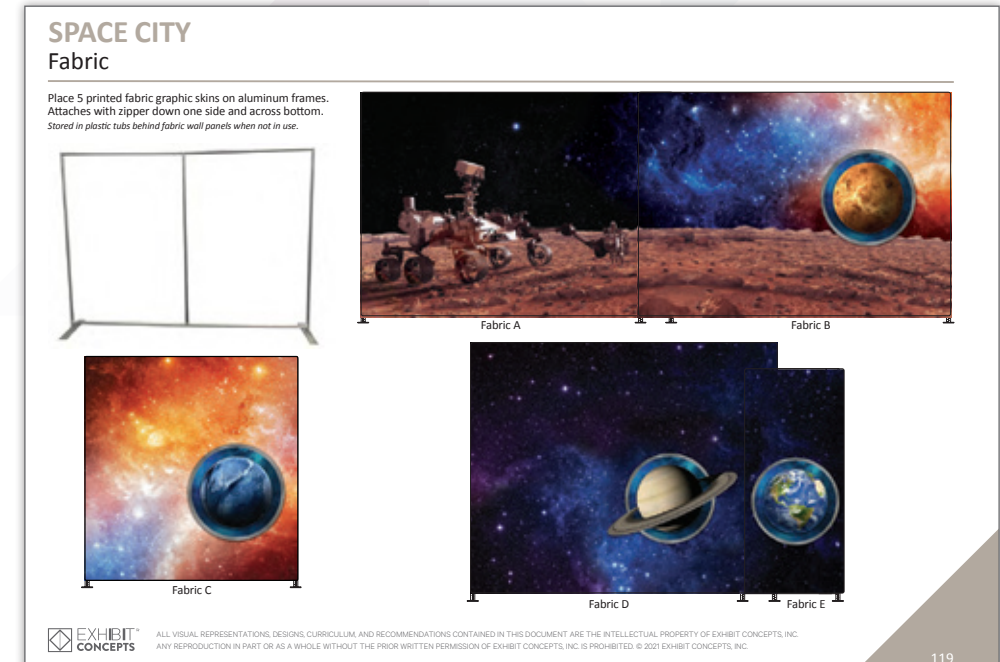
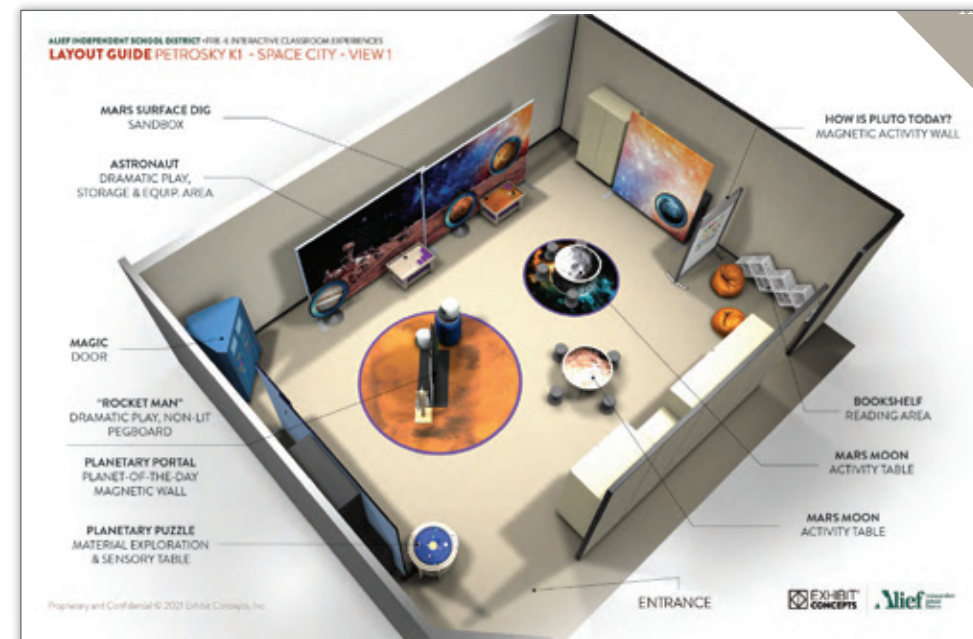

ACTIVITY & CLASSROOM RESOURCES



ACTIVITY & CLASSROOM RESOURCES

We co-develop curriculum support including activities and classroom resources, with our partners and clients.

These unique classroom supports, such as educator guides and associated materials, offer an enhancement to the learning environment.



ACTIVITY & CLASSROOM RESOURCES

DIGGING DINO



DIGGING DINOS
Prehistoric Landscapes
DD.20

VIII.C.1 Child identifies and creates common features in the natural environment.

Students manipulate kinetic sand to create landscapes for model dinosaurs. Students can browse through non-fiction books for landscape inspiration.

DOING THE ACTIVITY

- For easy clean-up, empty the Dino Play Sand Kit, dinosaur figures, and foliage into the container. This works well as a free choice, table-top activity.
- Encourage students to build landscapes with the malleable sand. Students can also collect items from outdoor walks like rocks, sticks and leaves to add to their landscape creations.

TEACHING STRATEGIES

- Use a tarp under the foldable "sandbox" to encourage students to make larger landscapes or landscapes that the children would like to keep out for a longer period of time.
- Use Insta-Snow (Steve Spangler) instead of sand in the container. Include the woolly mammoth figures, emphasizing the fact that woolly mammoths lived during a different period than the dinosaurs.

ALL VISUAL REPRESENTATIONS, DESIGNS, CURRICULUM, AND RECOMMENDATIONS CONTAINED IN THIS DOCUMENT ARE THE INTELLECTUAL PROPERTY OF EXHIBIT CONCEPTS, INC. ANY REPRODUCTION IN PART OR AS A WHOLE WITHOUT THE PRIOR WRITTEN PERMISSION OF EXHIBIT CONCEPTS, INC. IS PROHIBITED. © 2021 EXHIBIT CONCEPTS, INC.

EXHIBIT CONCEPTS

IN THIS KIT

DIGGING DINOS
Digging for Dino Bones
DD.14

...describes and discusses the

IN THIS KIT

DIGGING DINOS
Observations about Dinosaurs, Using AR

...to access appropriate information. ...navigates through digital learning applications.

...fundamental skills of technology and using Octagon Studios Flashcards. ...observations as they explore the

ACTIVITY

...device to use the Dinosaur of the brainsTEM app through the Google Play Store. Open the app. ...D card on a surface and scan camera. Input the serial number in

...the freedom to explore the dinosaur actions and skeleton ...students to observe how the ...moves and how the dinosaur sounds.

TEACHING STRATEGIES

- Use the Dinosaur 4D cards to introduce the new classroom. Find out what students already know about dinosaurs and make a list. Students can revisit the list before moving on to the next classroom.
- Use the 4D images as a picture guide for other activities such as Body Coverings DD.18 and Dinosaur Skeletons DD.21. Students can use the images for inspiration and reference.

ALL VISUAL REPRESENTATIONS, DESIGNS, CURRICULUM, AND RECOMMENDATIONS CONTAINED IN THIS DOCUMENT ARE THE INTELLECTUAL PROPERTY OF EXHIBIT CONCEPTS, INC. ANY REPRODUCTION IN PART OR AS A WHOLE WITHOUT THE PRIOR WRITTEN PERMISSION OF EXHIBIT CONCEPTS, INC. IS PROHIBITED. © 2021 EXHIBIT CONCEPTS, INC.

EXHIBIT CONCEPTS

ACTIVITY & CLASSROOM RESOURCES

PET VET



PET VET
Fish Counting
PV.11

VA.3 Child counts 1-10 items, with one count per item.
VA.9 Child recognizes one-digit numerals 0-9.

Students use one-to-one correspondence as they practice counting to 10 with faux fish and number identification cards. Students can use the faux fish to sort by self-selected categories or educator-suggested categories.

DOING THE ACTIVITY

- Use number cards 1-10 to introduce the activity. As children become comfortable with number cards 1-10, introduce additional numbers. Lay number cards 1-10 face down in a pile, in no particular order.
- Place the fish in a pile. Each child in the small group receives a fish bowl and chooses fish to put into their bowl (limit 10). One child starts by drawing a card and adding or subtracting that number of fish, either to their fish bowl or from their fish bowl. Once everyone has a turn to draw a card, continue drawing cards until the pile is empty. Ask students to count the final amount of fish in their bowl using one-to-one correspondence.

TEACHING STRATEGIES

- Use the fish counters and bowls to sort by type. Encourage children to count how many are in each sorted bowl.
- Students can use the fish counters and bowls in dramatic play. Add some water to the bowls and encourage play at the Red Flyer Wagon sensory table.

IN THIS KIT

EXHIBIT CONCEPTS

ALL VISUAL REPRESENTATIONS, DESIGNS, CURRICULUM, AND RECOMMENDATIONS CONTAINED IN THIS DOCUMENT ARE THE INTELLECTUAL PROPERTY OF EXHIBIT CONCEPTS, INC. ANY REPRODUCTION IN PART OR AS A WHOLE WITHOUT THE PRIOR WRITTEN PERMISSION OF EXHIBIT CONCEPTS, INC. IS PROHIBITED. © 2020 EXHIBIT CONCEPTS, INC.

PET VET
Playdough Exploration
PV.23

VA.3 Child counts 1-10 items, with one count per item.
VA.9 Child recognizes one-digit numerals 0-9.

Students use playdough to create pet figures and accessories. This activity supports fine motor skills and imaginative play.

DOING THE ACTIVITY

Students work in small groups to create pet figures using playdough. They can use the playdough to create different types of pets, such as dogs, cats, and birds. They can also create accessories like collars, leashes, and food bowls.

TEACHING STRATEGIES

- Label the bins for sorting materials in the dramatic play center. Labels show students where things belong and help acclimate them to frequently used word bank words.

IN THIS KIT

EXHIBIT CONCEPTS

ALL VISUAL REPRESENTATIONS, DESIGNS, CURRICULUM, AND RECOMMENDATIONS CONTAINED IN THIS DOCUMENT ARE THE INTELLECTUAL PROPERTY OF EXHIBIT CONCEPTS, INC. ANY REPRODUCTION IN PART OR AS A WHOLE WITHOUT THE PRIOR WRITTEN PERMISSION OF EXHIBIT CONCEPTS, INC. IS PROHIBITED. © 2020 EXHIBIT CONCEPTS, INC.

PRODUCTION & FABRICATION

Space Prep Drawings | Shop Drawings | Exhibit Fabrication
Exhibit Installation | Maintenance & Support



SPACE PREP DRAWINGS

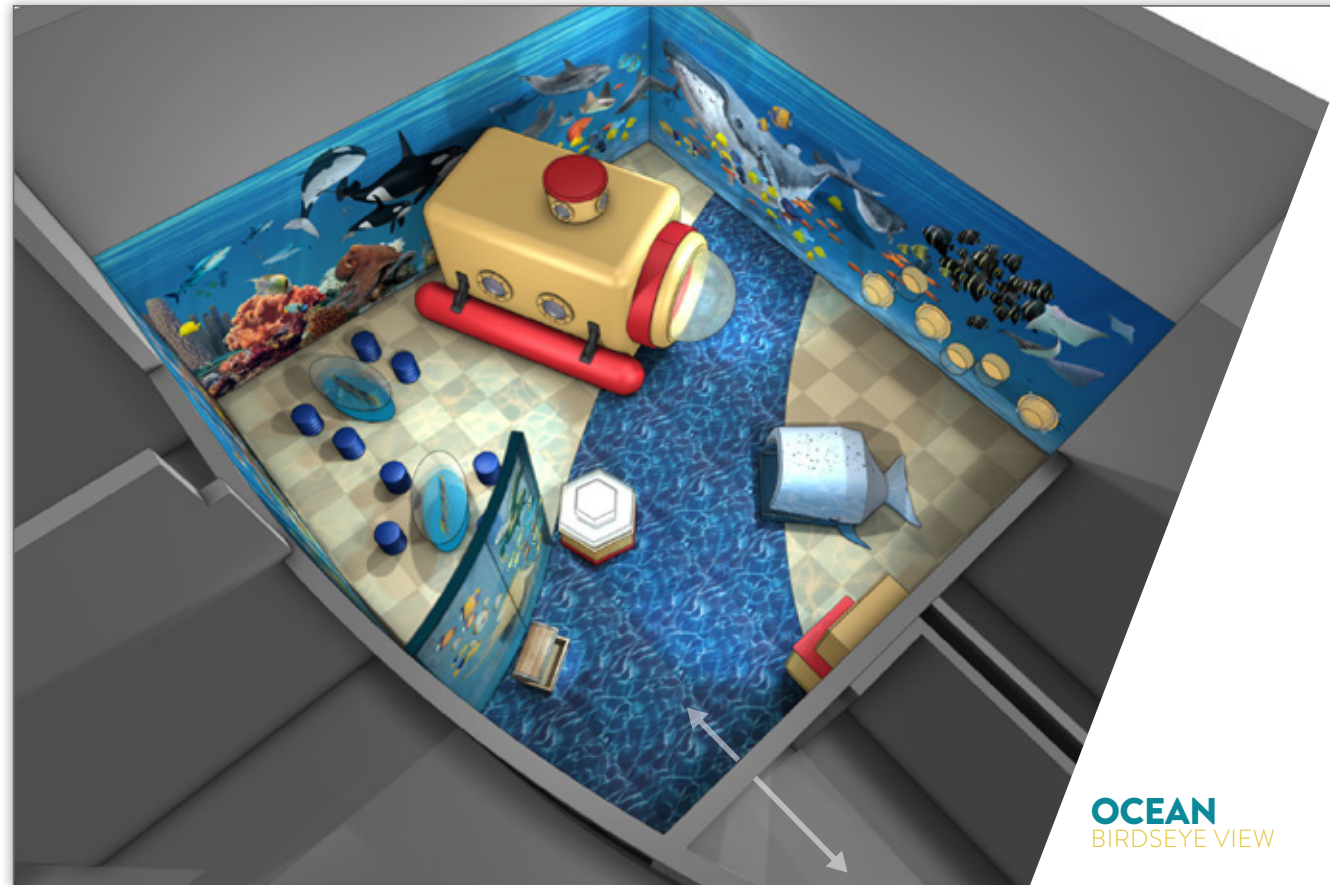

- Detailed Plans and Elevation
- Mechanical Locations
- Fabrication Overview

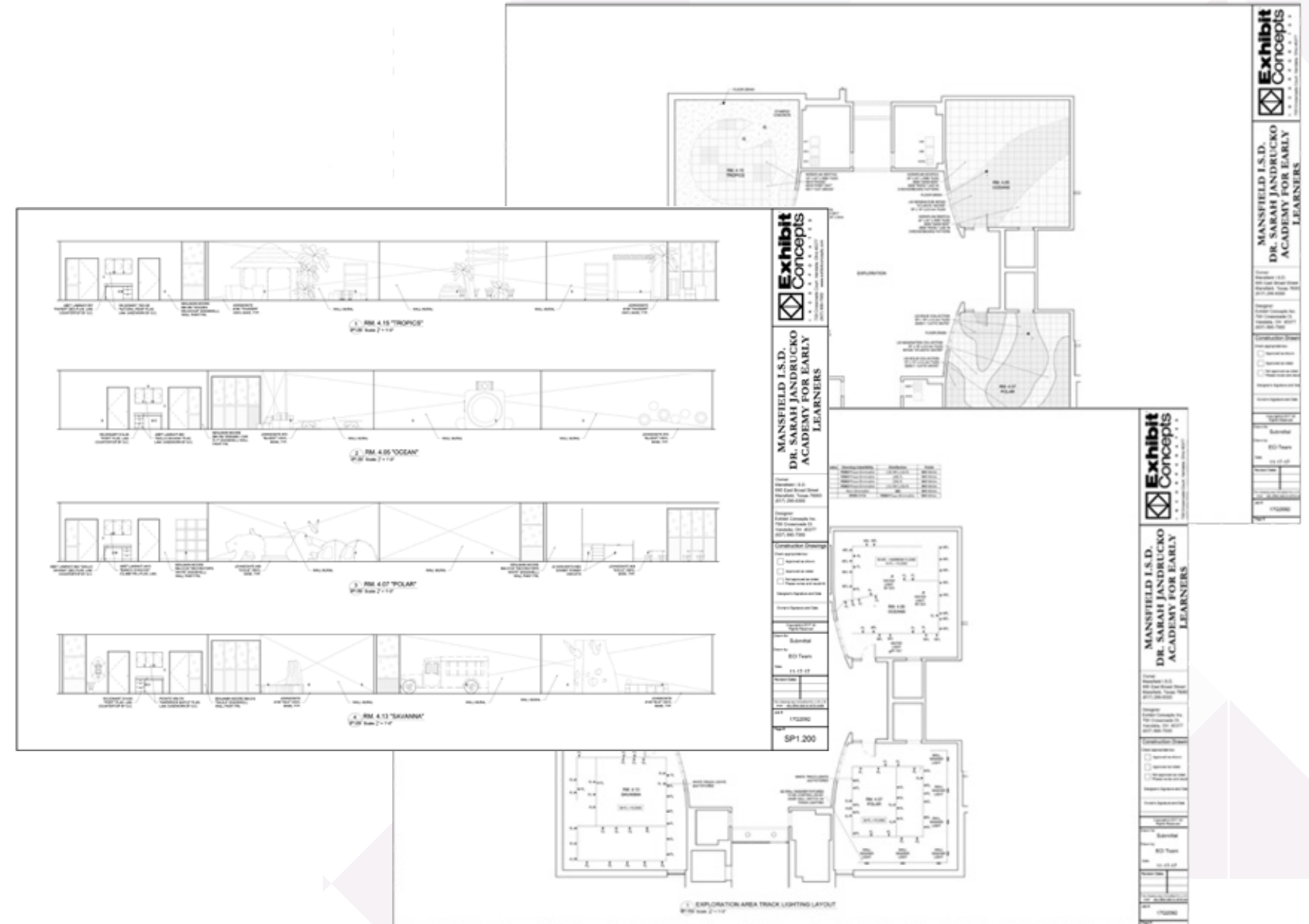

SHOP DRAWINGS



LET'S GET GOING
BIRDSEYE VIEW

- Detailed Drawings of Elements
- Highlights All Materials
- Used for Fabrication

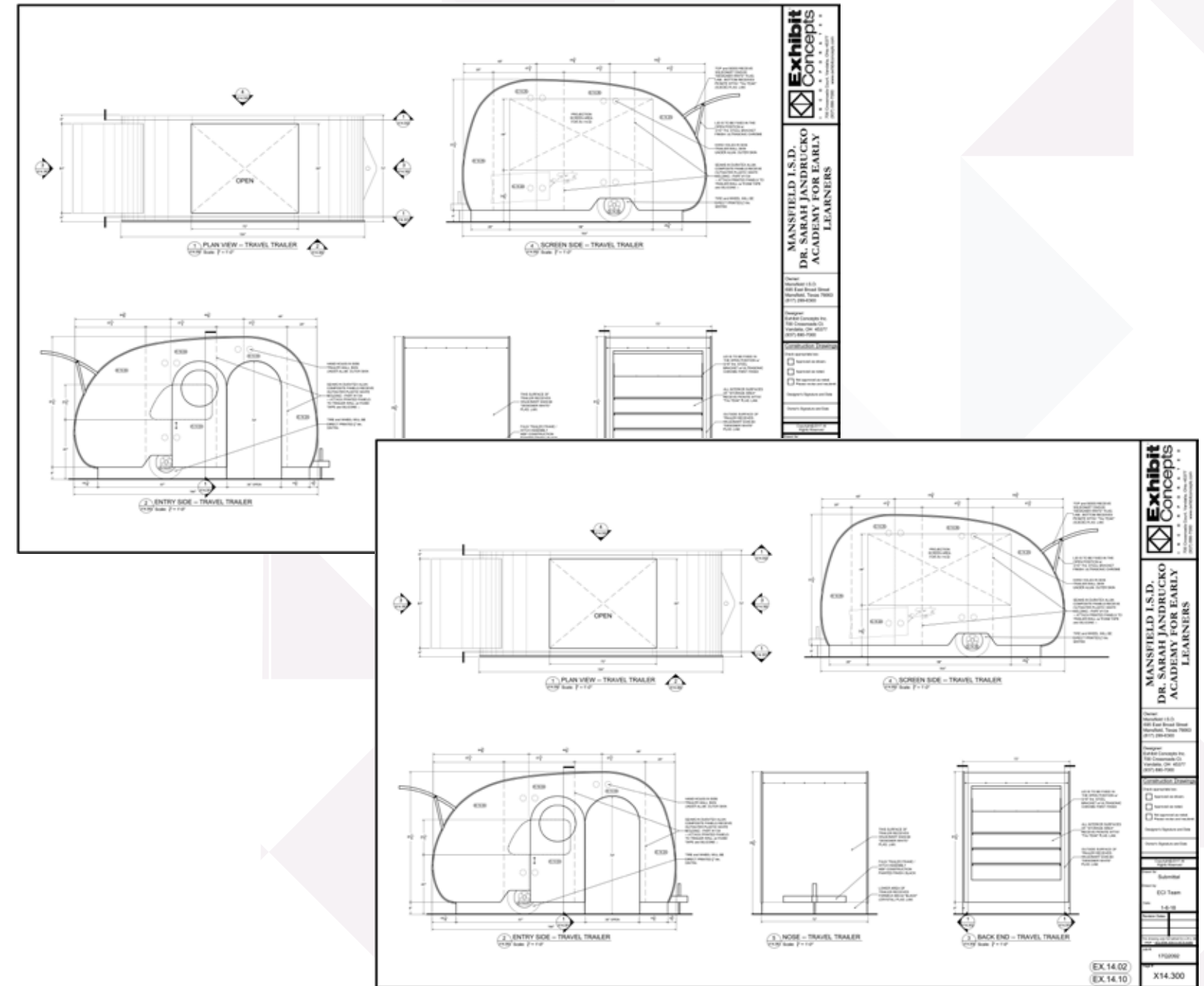

FABRICATION

Our technicians are accomplished in carpentry, composite fabrication, finished painting, and other processes.

- Project Management
- CNC Machining
- A/V and Media Integration
- Interactive and Responsive Electronics
- Graphic Production Management



INSTALLATION

Exhibit Concepts works closely with our clients through every phase of their project with detailed work plans and timelines for final installation.

- On-Site Project Managers and Installation Team
- Detailed Installation Work Plans
- Custom Packing and Crating
- Indoor and Weatherproof Outdoor Installations



MAINTENANCE & SUPPORT

Comprehensive maintenance manuals and follow-up repair services ensure an ongoing, engaging visitor experience with every exhibit we craft.

- Warranty (1 year from owner acceptance/contract close out time)
- Exhibit Refurbishment
- Operation and Maintenance Manuals
- Continued Advice and Support

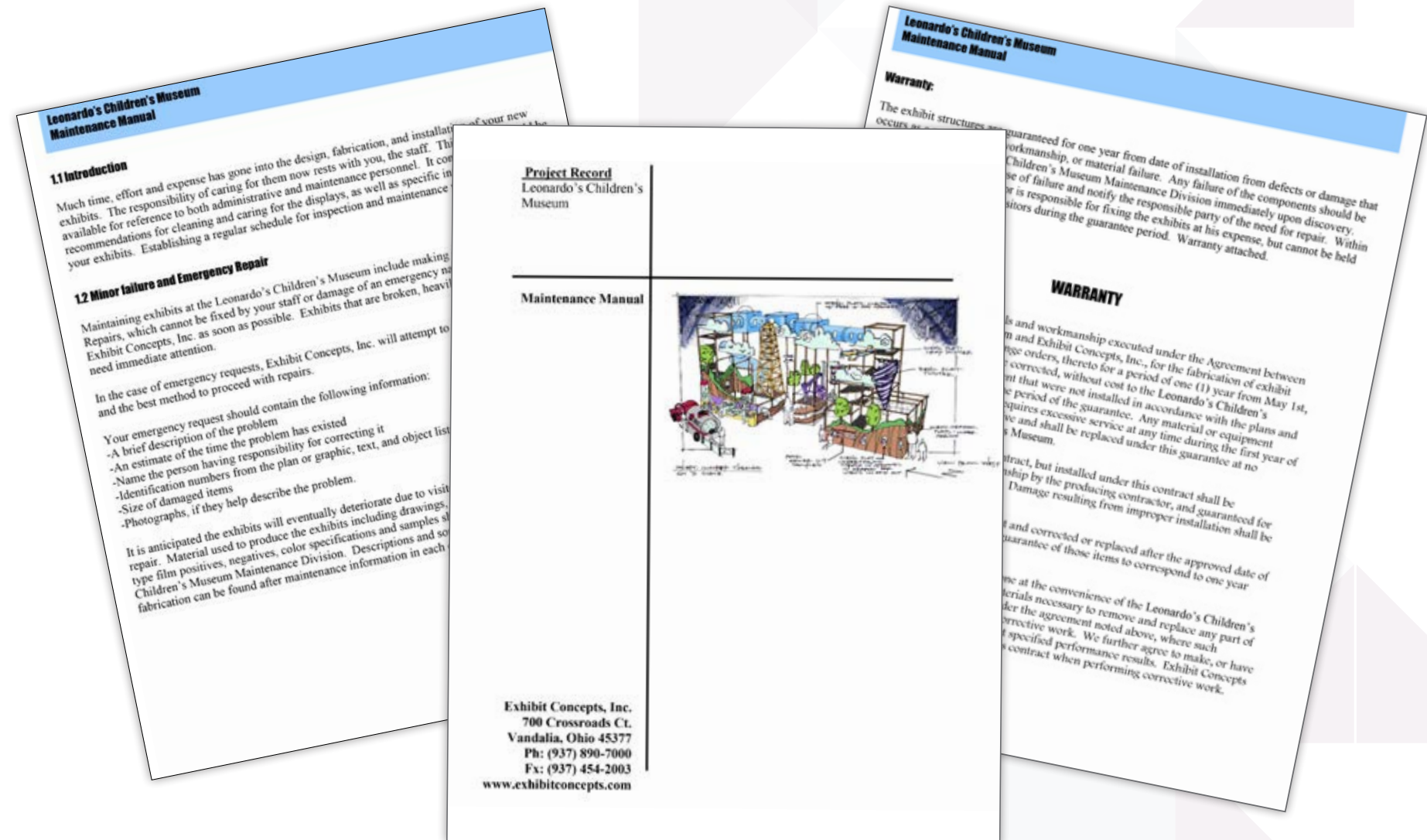

OUR COMPREHENSIVE SERVICES



DESIGN SERVICES

At Exhibit Concepts, we believe in the power of message-driven design. That's why we work hard to create innovative brand solutions that deliver magical storytelling experiences for your audience at every touchpoint.

Our design services provide a unique strategic process that connects your audience with your message in a powerful way. It's not enough to just be visually impressive. We design with behavior-driven purpose that inspires how your audience will think, what they will feel, and what they will do in response to your unforgettable exhibit.

To accomplish this, our team of creative problem-solvers collaborates closely with your team to develop the following design strategies:



1. RESULTS-DRIVEN GOALS AND OBJECTIVES

Unforgettable design is purposeful, and carefully planned objectives sets the foundation for every design decision.



2. TARGET AUDIENCE PROFILES

We profile your target audience(s). Who is your current audience? Is it the right audience for your goals? What are the characteristics of that chosen audience? What is the most effective way to connect with that audience to achieve your goals?



3. YOUR BRAND STORY

We work with you to connect stories, products, and the "why" of your organization to your audience — and we make certain that connection will drive us toward your outcome driven goals.

After setting a strong strategic foundation, we then proceed into the design concept phase where we work closely with you to develop the look and feel that best captures your intent and accomplishes your visitor experience goals.

FABRICATION & INSTALLATION SERVICES



Exhibit Concepts has a proven track record of producing and installing museum-quality exhibit components. Our team brings together some of the best in the business when it comes to award-winning, fabrication. Whether we're working from our own designs or working with a design partner, we're experts at bringing your creative vision to life.

We build prototypes, models, and source materials to ensure fabrication goes smoothly, and that what you see in the design phase is what you really get in fabrication. We also take a critical eye to every opportunity for value engineering, aligning your objectives with your designs and suggesting materials and methods that achieve your goal with the most cost-effective solutions.

As an ongoing and post-production quality control measure, we have large areas within our 232,000 sq. ft. buildings that are specifically dedicated to the complete set-up, integration, and testing of all exhibit components. This allows our production team, and our client, to view all elements working together under real-world conditions to ensure perfect alignment prior to delivery and installation.

Final delivery begins in our warehouse, where items are carefully packaged in crates, loaded onto the truck, and then installed and overseen by on-site supervisors.

Service delivery is the cornerstone of our business. We fabricate, prep, and install our projects flawlessly, with nothing missing or incorrect. We take every measure to deliver on-time, on-budget, and on-target, every time.

STAFF TRAINING

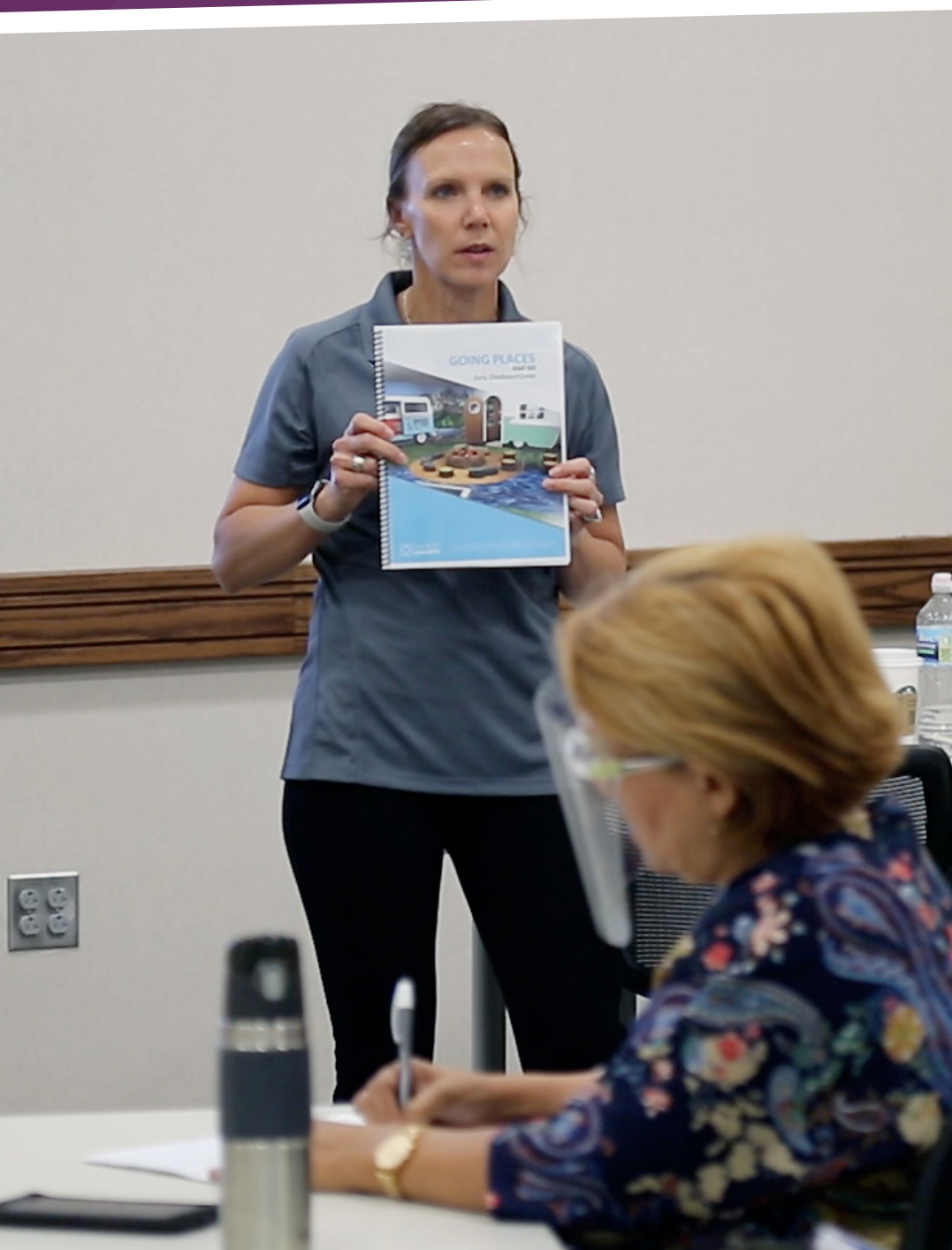

- Our experts come to you for training
- Educators are introduced to classroom support
- Opportunity for collaboration
- Qualifies for CEU credits



EXPERIENTIAL MEDIA

Our goal is to immerse your audience in unforgettable stories that inspire them to act, learn, and grow. Engagement is the key to transforming information into compelling messages and hands-on experiences.



PHOTOGRAPHY & VIDEOGRAPHY



GAMIFICATION



MEDIA & CONTENT MARKETNG



AUGMENTED REALITIES

NEXT lab™ Take engagement to the next level with our NEXT lab! The NEXT lab is a dynamic, experiential, and creative team dedicated to developing unique virtual and digital experiences through creative technologies.

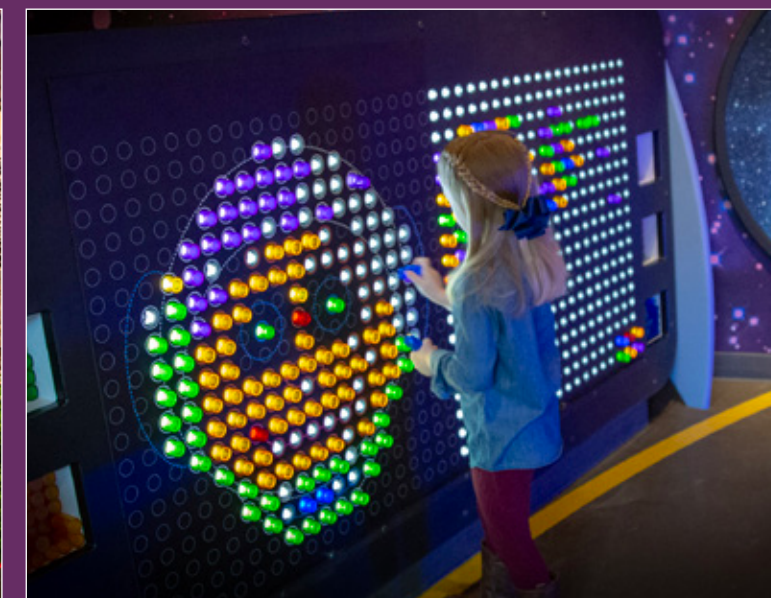

RESULTS

High Quality Learning Environment

- A deeper understanding of content
- Simulated real-world environment
- Increased interest
- Provide opportunity for reflection

Broader Support of Diversity, Equity, and Inclusion

- Children see themselves as learners
- Activities and materials support offers a wide range of development needs



Academy for Early Learners
Mansfield ISD

THANK YOU

STEVEN LOWRY

Account Executive

slowry@exhibitconcepts.com

office: 937-535-0261

mobile: 937-478-7366

THANK YOU

JENNY WARD

Account Executive

jward@exhibitconcepts.com

office: 937-535-0206

mobile: 513-594-7400